



Installation Manual Double DIN Kit

piano-black: 381178-38-1

• Kia Rio (Type UB/facelift) 03/2015->

Compatible with these Double-DIN devices:

Double-DIN Navigation

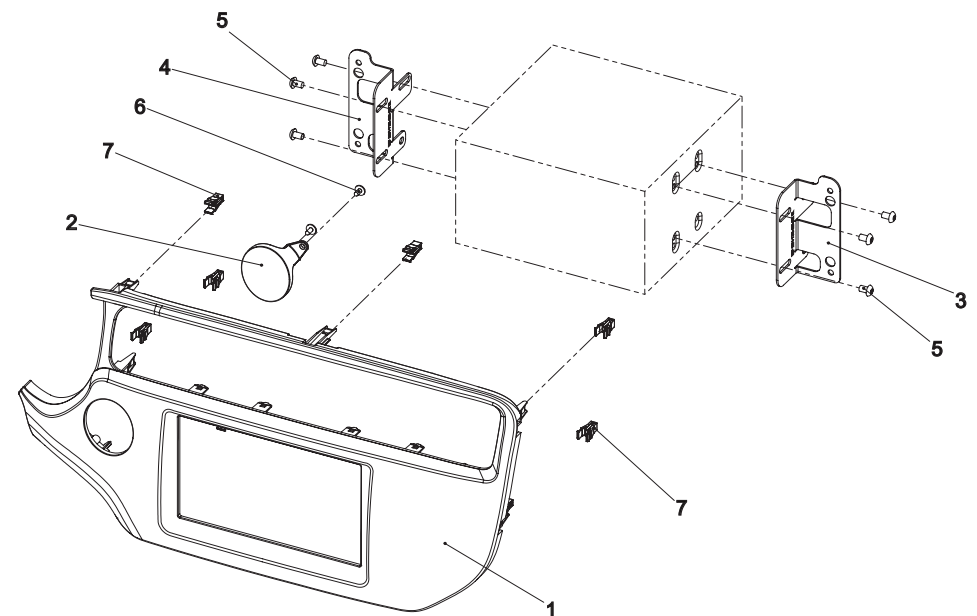

Double DIN Set contents

- (1) Facia Plate
- (2) Cover* (for models without „start/stop“ button)

- (3) Mounting bracket right
- (4) Mounting bracket left
- (5) flat headed screw
- (6) self-tapping screw with collar
- (7) Clips



1. Unclip OEM panel (see arrows)



2. Unplug connector of hazard light switch

Remove panel

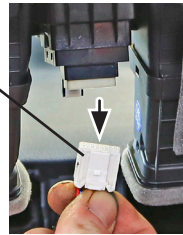

3. Remove 4 screws of OEM head unit



4. Unplug all cables and connectors carefully

Remove OEM head unit



- Remove air vents from OEM panel



6. Remove OEM clips from OEM panel

Mount OEM clips to
new facia plate

Mount air vents to new fascia plate

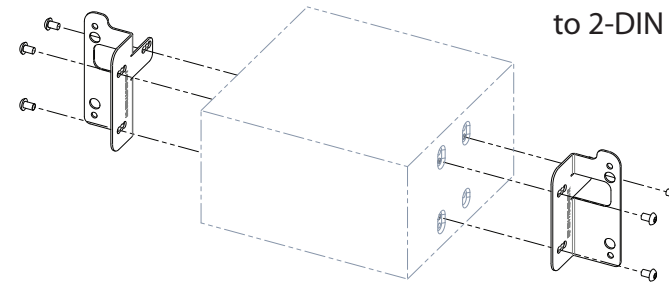

7. Mount metal brackets to 2-DIN head unit

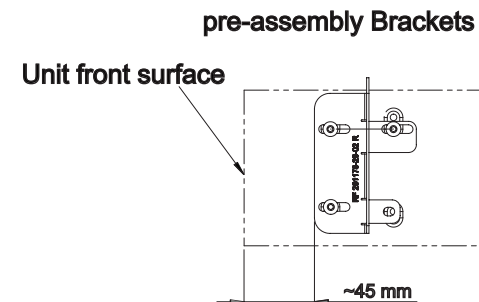

We recommend a distance about 45 mm to the front surface of the 2-DIN head unit

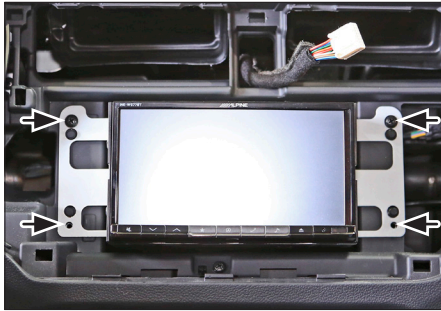
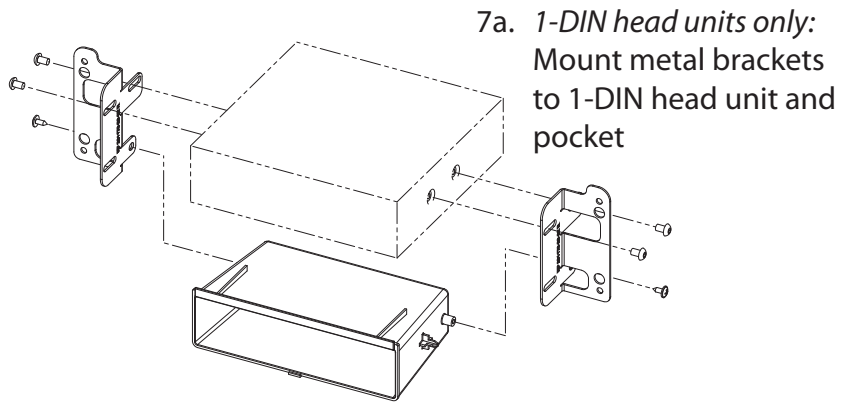

8. Connect all required circuit points and mount head unit on dash board using the 4 OEM screws removed in step (3)

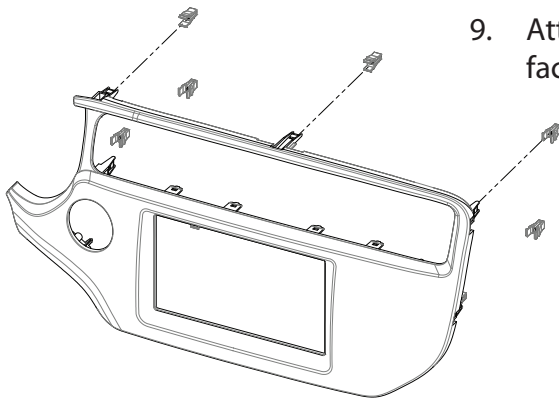

10. Mount air vents to
new facia plate



11. **Kia Rio with start/stop:**
Remove start/stop button
Mount start/stop button
to new facia plate

Kia Rio without start/stop:
Attach cover to facia plate



12. Connect all required
circuit points

Place facia plate on
dash board